

V10:

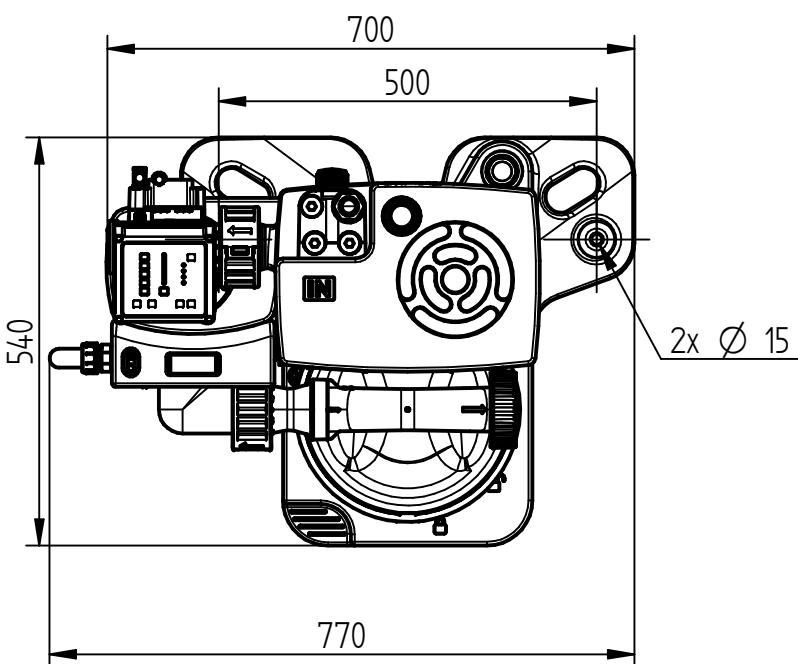
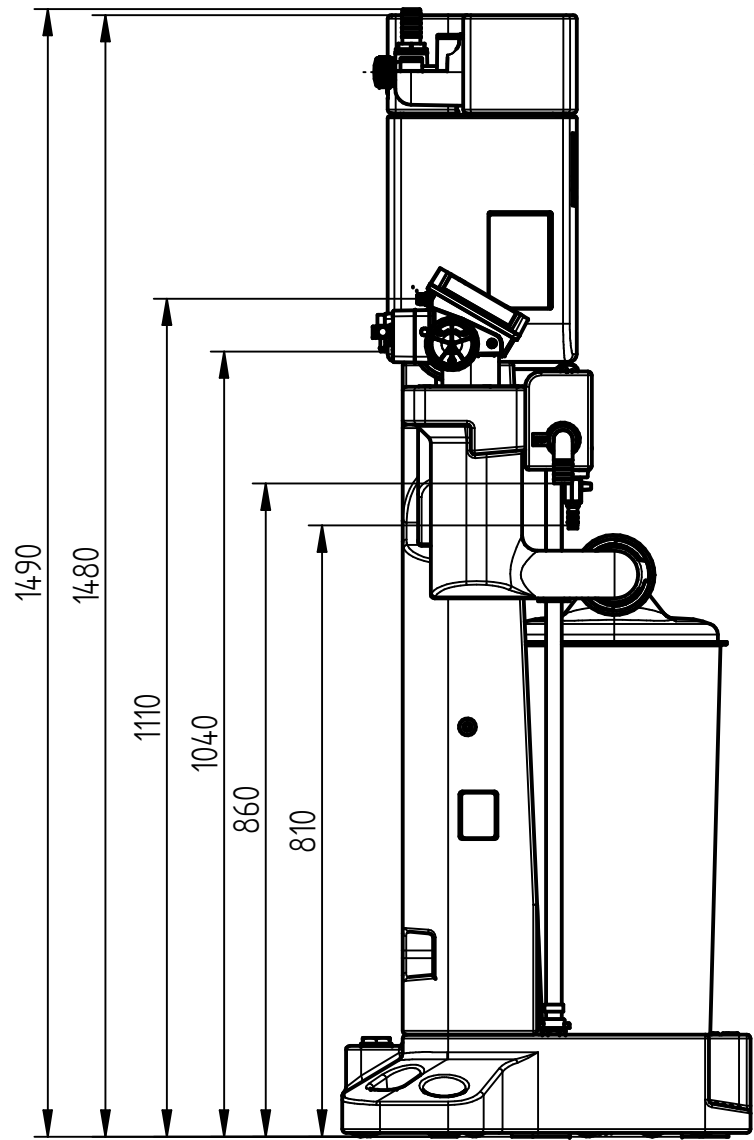
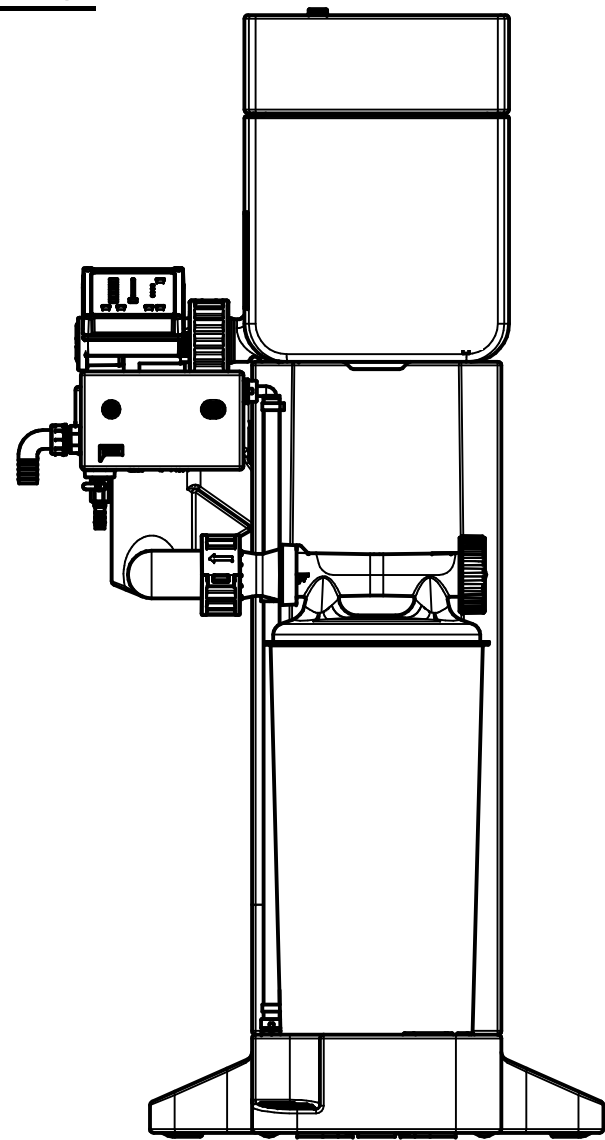

Verriegelung Messkammer & Reinwasserbehälter /
locking measuring chamber & pure water tank

Steuerung (FRC) /
electronic device (FRC)

Messkammer & Reinwasserbehälter /
measuring chamber & pure water tank

Reinwasserausgang/
water OUT
(ϕ 23mm)

Testhahn/
test valve

Steigkanal /
ascension pipe

Verriegelung Standfuss /
locking pedestal

Befestigungspunkt/
mounting point

Kondensatzulauf/
condensate IN
(3x G1/2, 1x G1)

Schwimmer/
flush type fluid indicator

Druckentlastungskammer/
pressure release chamber

Abschlusskappe /
end cap

Kartusche /
cartridge

Standfuss /
pedestal

Reinigungsöffnung/
cleanout

Sammler /
collection drain